

NW COR. SEC. 21
FO. ROCK CAIRN.

N 1/4 COR. SEC. 21
SET # 5 RE-BAR & CAP RLS 1871
& MOUNDED ROCKS AROUND
SAME @ FENCE CORNER.

N. 89° 23' 42" E.
2674.23'

N. 89° 17' 32" E.
2670.88'

400'

N. 38° 02' 50" W.

PT-C-605+80.44

NE COR. SEC. 21 &
NW COR. SEC. 22.
FOUND ROCK CAIRN.

N. 89° 20' 12" E.
1315.05' (CALC.)

NOT FOUND
OR SET.

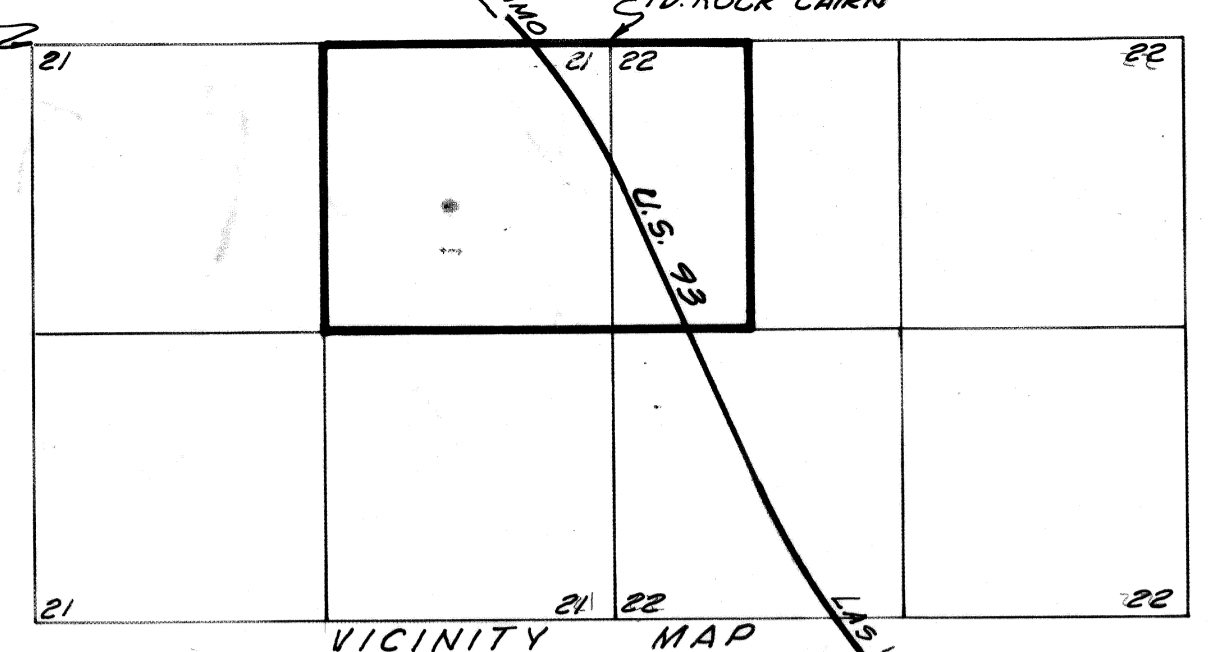

NORTH

N. 0° 33' 48" W.
2650.80'

162.82 AC. GROSS

80.53 AC. GROSS
(CALC.)

2666.57' (CALC.)

N. 0° 32' 46" W.

NORTH
SCALE: 1"=200'

400'

325'

U.S. 93

PC-C-590+44.55

E 1/4 COR. SECTION 21
SET # 5 RE-BAR & CAP RLS 1871
1/8' NORTH OF FENCE LINE.
(NW COR. SECTION 22)

FENCE COR ON E-W
MID-SECTION LINE.

325'

400'

N. 28° 30' 20" W.

NOT FOUND
OR SET.

436'

C 1/4 COR. SEC. 21
SET # 5 RE-BAR & CAP
RLS 1871 & MOUNDED
ROCKS AROUND SAME.

FENCE LINE ON E-W
MID-SECTION LINE.

2667.59'
N. 89° 33' 40" E.

SET RE-BAR
ON R

14.5'

SET RE-BAR
ON R

350'

760'

201.27'

405.78'

N. 89° 28' 42" E.
1317.53' (CALC.)

400'

No. 48080

Filed at Request of Nelson E.
Myer at 9:01 A.M. on Aug 25, 1969

Nelson E. Myer
Lincoln County, Nevada, Recorder

I, NELSON E. MYER, DO HEREBY CERTIFY THAT THE SURVEY
PLATTED HEREON WAS MADE UNDER MY DIRECTION AND
WAS COMPLETED ON THE 14TH DAY OF MARCH, 1969, AT THE
INSTANCE OF FLOYD LAMB.

Nelson E. Myer
NELSON E. MYER
RLS 1871-NEVADA.



BASIS OF BEARINGS PER
NEVADA STATE HWY. DEPT.

DELTA SURVEYING INC.
LAS VEGAS, NEVADA.

Job No. 690201

**RESULTS OF SURVEY
OF THE
NE 1/4 SECTION 21 & W 1/2 NW 1/4 SEC. 22,
T. 7 S., R. 61 E., M. D. B. & M.,
LINCOLN COUNTY,
NEVADA.**

FOR
FLOYD R. LAMB